

AMERICAN RIFLE COMPANY
COUP DE GRÂCE
Barrel Interface Specification
Rev B, 28 Feb 2023

WARNING

The information contained herein is intended for use only by properly trained gunsmiths and is to serve only as a guide for chambering and threading barrels to be used with American Rifle Company's Coup De Grâce bolt action. The use of a firearm having an improperly chambered and threaded barrel can be extremely dangerous to the user of the firearm and to bystanders. Chambering and threading barrels should be performed only by properly trained gunsmiths. American Rifle Company assumes no responsibility for events transpiring as a result of the use of this document and makes available neither advice nor assistance for chambering and threading barrels. Use this document at your own risk.

Coup De Grâce - Conical Breech

A conical entry to the chamber is required for cartridges having a case head diameter less than or equal to 12.7mm (0.500in) but can optionally be used for those with larger heads as well.

This conical breech design is **NOT COMPATIBLE** with American Rifle Company's other actions, the Mausingfield, Nucleus, and Archimedes.

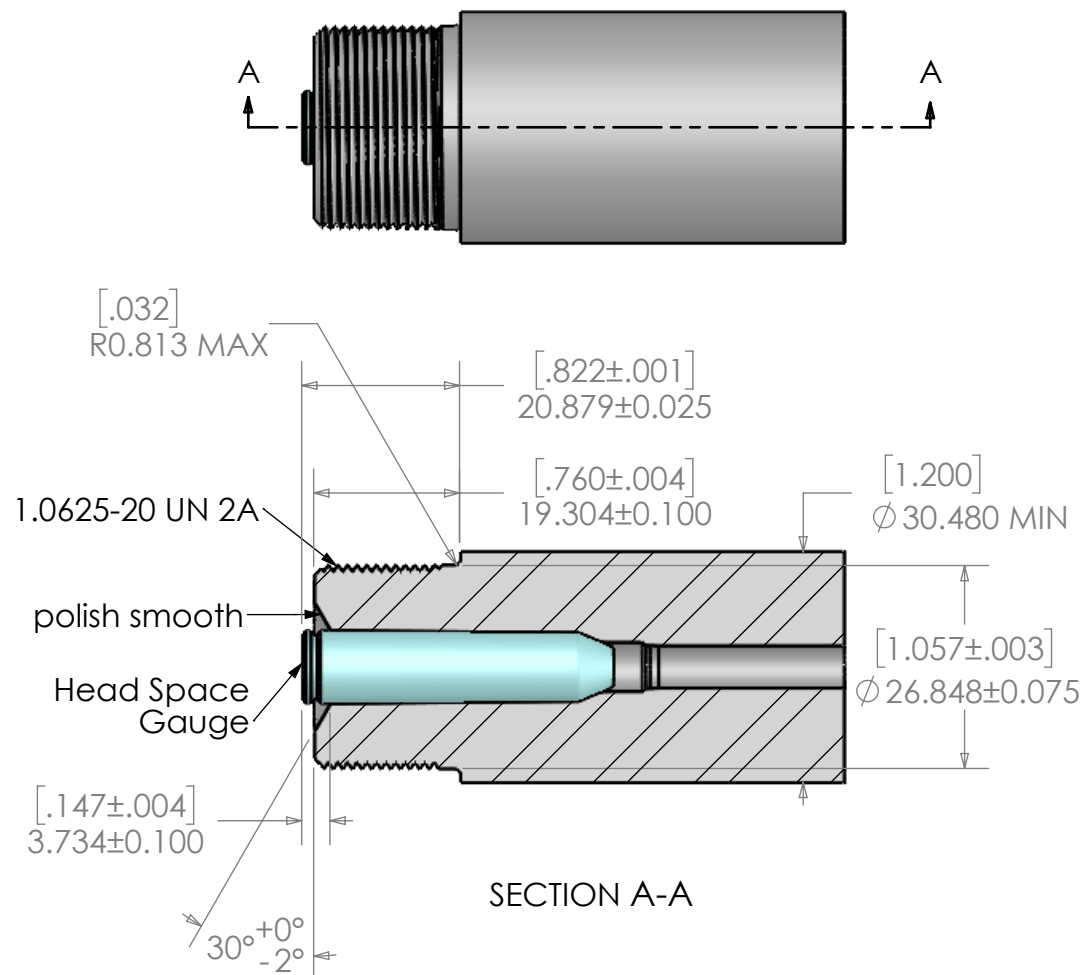

Suggested Method for Measuring Cone Location

A ball can be used to accurately measure the location of the conical breech entry as shown below. DimA is cartridge specific. You can either measure it directly or look it up in either the SAAMI or CIP standards.

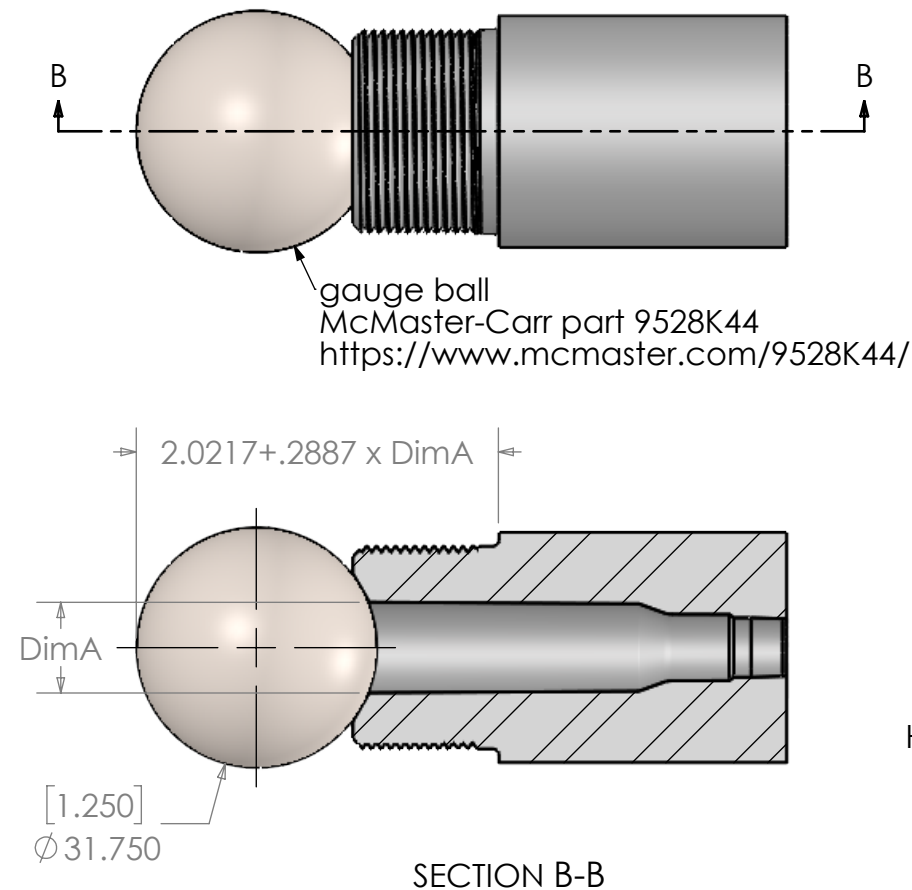

Coup De Grâce - Flat Breech

Can be used for cartridges having a case head diameter greater than 12.7mm (0.500in).

This flat breech design is **COMPATIBLE** with American Rifle Company's other actions, the Mausingfield, Nucleus, and Archimedes.

